



Interior Features

- Black Appliance Packages*
- Microwave Oven*
- Dishwasher*
- Garbage Disposal*
- Ceiling Fans
- Updated Lighting
- New Flooring
- New Paint
- Resurfaced Kitchen & Bath Countertops
- New Shower Enclosures
- Large Closets

Community Amenities

- Playground
- Onsite Laundry Facilities
- Newly Painted
- Walking Distance To Schools
- Convenient To Shopping, Dining and Entertainment

Our 1, 2 & 3 bedroom floor plans have something for everyone. View our apartment homes and community amenities, and call or use the form below to schedule your personal tour today!

Shopping, Dining and Entertainment - it's all right here - within minutes of Sadosa Ridge!

Visit us today and make Sadosa Ridge your new home!



Professionally Managed by



600 W. Sadosa Street
Eastland, TX 76448

(254) 271-1306

(254) 629-2682 (Fax)

*In Select Apartment Homes

1 Bdrm / 1 Bath
646 Sq. Ft.*

RENT _____
DEPOSIT _____



3 Bdrm / 2 Bath
1,008 Sq. Ft.*

RENT _____
DEPOSIT _____

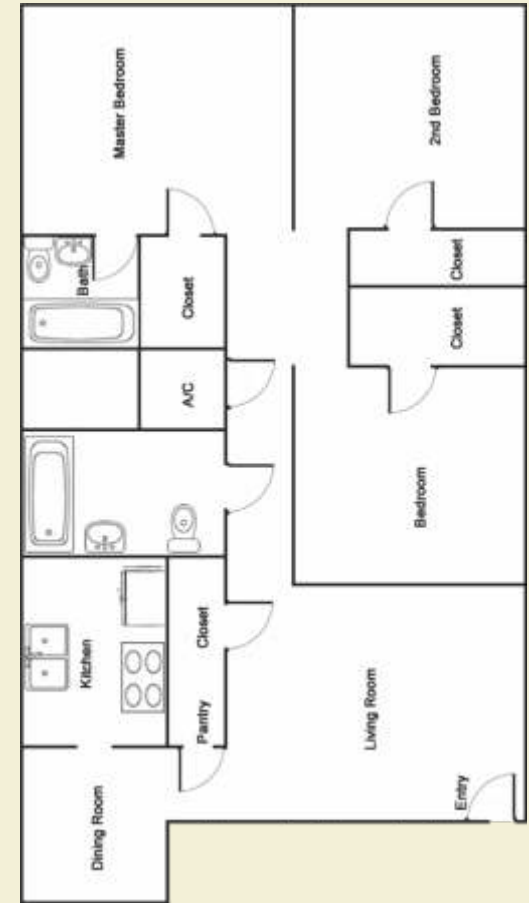

2 Bdrm / 1 Bath
896 Sq. Ft.*

RENT _____
DEPOSIT _____



600 W. Sadosa Street
Eastland, TX 76448
(254) 271-1306
(254) 629-2682 (Fax)

* All Square Footage is Approximate Only.